



Product Specifications Sheet

Product Name Basin Faucet 14801QT

SKU 14801QT (PC)

Product Measurements

Overall Height	144mm
Spout Height	93mm

HS Code 8481809000



Product Reference Image

Product Description

Basin Faucet, Model No: 14801QT (PC), a sleek and contemporary addition to your bathroom. Crafted with precision, this faucet boasts a lead-free design, ensuring both safety and environmental consciousness. The chrome finish not only provides durability but also adds a touch of sophistication to your basin area. With cUPC certification, you can trust in the quality and compliance of this faucet.

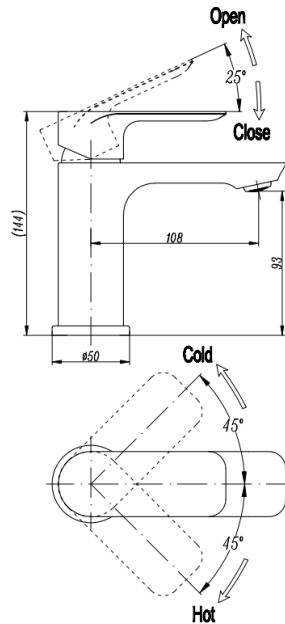

14801W-D125

Key Features

- Lead Free Brass Body
- Metal Handle
- Lead Free Brass Waterway
- Flow Rate: 1.8 gpm

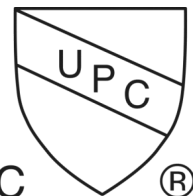

Warranty Information

PASGO faucet warrants the original purchase (must have prove of purchase) that such product is free from defect in materials or workmanship for as long as the original consumer purchaser owns their home from the date of purchase. This warranty is limited to but not including labor charges incurred in/or damages sustained during installation, repair or replacement, nor incidental or consequential damages. This warranty does not cover items which are received secondary finishing or have been altered or modified after purchase, or for defects raised by physical abuse to or misuse of the product. This warranty gives the original purchaser of a PASGO faucet specific legal rights which may vary from state to state or from province to province. In some states or provinces the exclusion or limitation incidental or consequential damages is not allowed, for those exclusions may not apply to you.

Thank you for your purchase

Basin Faucet Installation

REMARK: CLEAN THE PIPE BEFORE INSTALLATION.

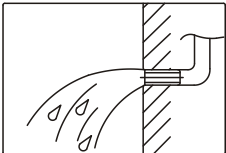

In order to avoid the obstruction of faucet, must to clean the impurities and sludge of pipe, before assembly.

FAUCET INSTALLATION STEPS

1. Before installation, please make sure there is a hole ($\varnothing 36$) on the table-board. Refer to draft (A)
2. To fix the screw and flexible hose in turn. Refer to draft (B)
3. Put the plastic washer on those two flexible hose then take the main body and those two flexible hose stagger across the hole which on the table-board. Refer to draft (C)
4. Put the plastic washer and metal washer on the screw and tighten the screw nut to fix the faucet on the table-board. Refer to draft (D)
5. To connect the angle valve and tighten it by wrench. Close the switch of faucet and open the switch of angle valve, keep pressure 30 minutes. To check the faucet connect parts to see if it got leakage problem. Refer to draft (E)

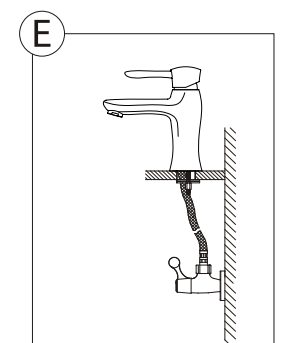
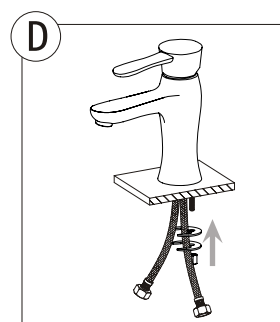
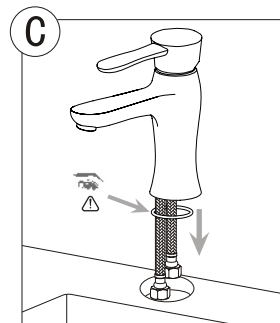
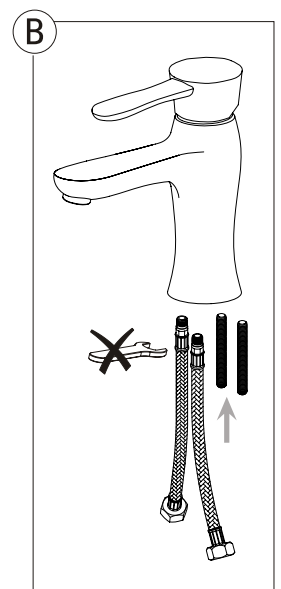
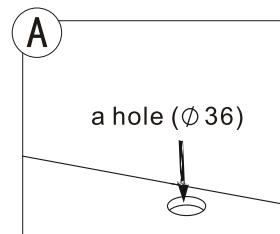

FAUCET INSTALLATION STEPS

1. Before installation, make sure there is a hole ($\Phi 36$) on the table top. Refer to draft (A).
2. Put the two inlet pipes of the faucet body through the hole which is on the table top. Make sure the washer is on the body. Refer to draft (B)
3. Put the plastic washer and metal washer on the fixing screw and tighten the fixing nut to fix the faucet on the table top. Refer to draft (C)
4. Connect the angle valve and tighten it by wrench. Close the switch of faucet and open the switch of angle valve, keep pressure for 30 minutes, to check if it leaks at all connections. Refer to draft(D).

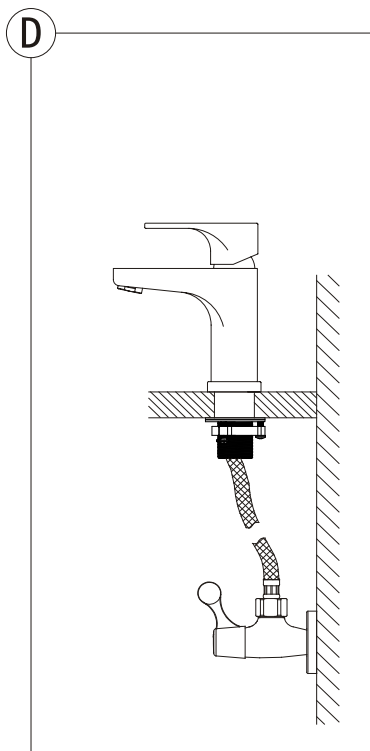
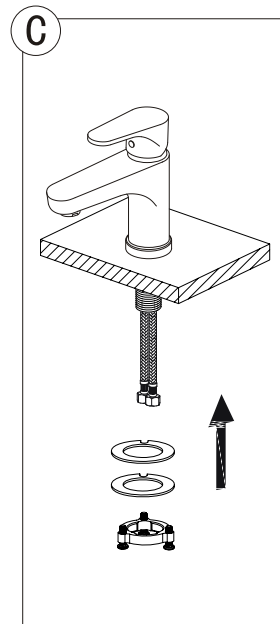
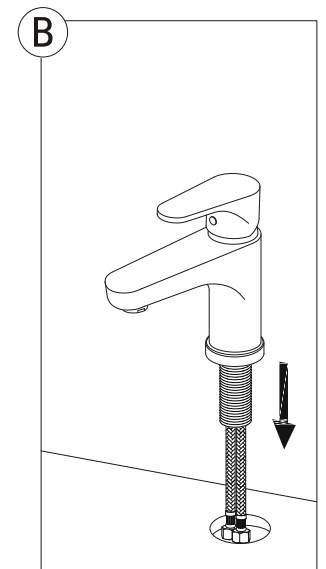
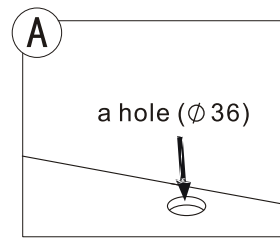

INSTRUCTIONS

Upturn the handle to open the water. The larger the angle is, the larger the flow is. Reset is closed.

Turn left the handle, more hot water:
Turn right the handle, more cold water

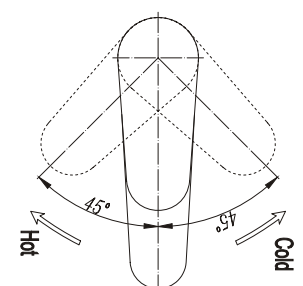
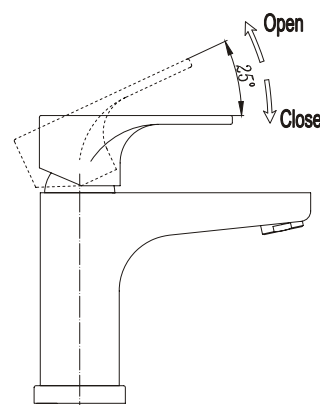

IAPMO RESEARCH AND TESTING, INC.

5001 E. Philadelphia Street, Ontario, CA 91761 • Phone (909) 472-4100 • Fax (909) 472-4244 • www.iapmort.org



CERTIFICATE OF LISTING

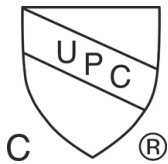

IAPMO Research and Testing, Inc. is a product certification body in which its product certification system includes inspection and testing of samples taken from the supplier's stock or from the market or a combination of both to verify compliance to the requirements of applicable codes and standards. This activity is coupled with periodic surveillance of the supplier's factory and/or warehouses as well as the assessment of the supplier's Quality Assurance System. This listing is subject to the conditions set forth in the characteristics below and is not to be construed as any recommendation, assurance or guarantee by IAPMO Research and Testing, Inc. of the product acceptance by Authorities Having Jurisdiction.

Issued To:

KAIPING PASGO PLUMBING PRODUCTS CO., LTD.

NO.223 JIAXING NORTH ROAD SHUIKOU TOWN KAIPING , GUANGDONG, CHINA

Product:

Plumbing Fixture Fittings

Products are in compliance with the following code(s):

Uniform Plumbing Code (UPC®)
National Plumbing Code of Canada
National Standard Plumbing Code

Products are certified to the following standard(s)

ASME A112.18.1-2018/CSA B125.1-18

File Number: 10068

Effective Date: November 2019

Void After: November 2024*

Chairman, Product Certification Committee





Chief Technical Service Officer

*This certificate is not evidence of current listing. To verify listing status, visit the IAPMO R&T Product Listing Directory at pld.iapmo.org

This listing period is based upon the last date of the month indicated on the Effective Date and Void After Date shown above. Any change in material, manufacturing process, marking or design without having first obtained the approval of the Product Certification Committee, or any evidence of non-compliance with applicable codes and standards or of inferior workmanship, may be deemed sufficient cause for revocation of this listing. Production of or reference to this form for advertising purposes may be made only by specific written permission of IAPMO Research and Testing, Inc. Any alteration of this certificate could be grounds for revocation of the listing. This document shall be reproduced in its entirety.

IAPMO RESEARCH AND TESTING, INC.

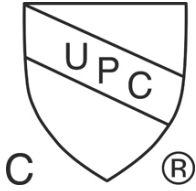
CERTIFICATE OF LISTING



Issued To: KAIPING PASGO PLUMBING PRODUCTS CO., LTD.

Effective Date: November 2019

File Number: 10068

Product: Plumbing Fixture Fittings

Void After: November 2024

This certificate is not evidence of current listing. To verify listing status, visit the IAPMO R&T Product Listing Directory at pld.iapmo.org

Identification:

Plumbing supply fittings shall be marked with the manufacturer's recognized name, trademark, or other mark or, in the case of private labeling, the name, trademark or other mark of the customer for whom the fitting was manufactured. The marking shall be accomplished by use of a permanent mark or by placing a permanent label on the product. Markings on plumbing supply fittings shall be visible after installation.

Showerheads and hand-held showers shall be marked with the manufacturer's specified maximum flow rate, in L/min and gpm.

Kitchen, lavatory, and metering faucets shall be marked with the manufacturer's specified maximum flow rate, in L/min and gpm or L/cycle and gpc.

Single-handle and single-control bath and shower mixing valves shall have their temperature control settings identified alphabetically, numerically, or graphically.

High-efficiency commercial pre-rinse spray valves shall be marked with the manufacturer's specified maximum flow rate, in L/min (gpm).

Listed products shall bear the cUPC® certification mark.

Packaging for plumbing supply fittings shall be marked with the manufacturer's name, trademark, or other mark as well as the model number or, in the case of private labeling, the name, trademark, or mark of the customer for whom the fitting was manufactured as well as the model number.

Packaging for showerheads and hand-held showers shall be marked with the manufacturer's specified maximum flow rate and either the manufacturer's specified minimum flow rate or the statement "For use with automatic compensating valves rated at xxx L/min (yyy gpm) or less", where xxx L/min (yyy gpm) is the manufacturer's specified minimum flow rate.

Packaging for kitchen, lavatory, and metering faucets shall be marked with the manufacturer's specified maximum flow rate, in L/min and gpm or L/cycle and gpc.

Characteristics:

Fittings may include lavatory, sink, bath & shower, lawn and sediment faucets. Plumbing fixture fittings to be installed in accordance with the manufacturer's instructions and the requirements of the latest edition of the Uniform Plumbing Code and National Plumbing Code of Canada.

Products listed on this certificate have been tested by an IAPMO R&T recognized laboratory. This recognition has been granted based upon the laboratory's compliance to the applicable requirements of ISO/IEC 17025.

IAPMO RESEARCH AND TESTING, INC.

CERTIFICATE OF LISTING

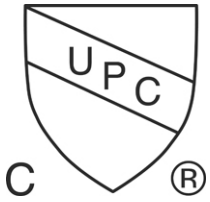

Issued To: KAIPING PASGO PLUMBING PRODUCTS CO., LTD.

Effective Date: November 2019

File Number: 10068

Product: Plumbing Fixture Fittings

Void After: November 2024

This certificate is not evidence of current listing. To verify listing status, visit the IAPMO R&T Product Listing Directory at pld.iapmo.org

Models

Model Number	Description
11078QT*	Kitchen Faucet
11088QT*	Kitchen Faucet
11098QT*	Kitchen Faucet
11401QT*	Basin Faucet
12574*	Free standing shower Faucet
13201QT*	Basin Faucet
13801QT*	Basin Faucet
13805QT*	Kitchen Faucet
14874*	Free standing shower Faucet
1508QT*	Kitchen Faucet
15301QT*	Basin Faucet
15305QT*	Kitchen Faucet
15398QT*	Kitchen Faucet
15401QT*	Basin Faucet
15598BQT*	Kitchen Faucet
15803QT*	Basin Faucet
15805QT*	Kitchen Faucet
16001QT*	Basin Faucet
16401QT*	Basin Faucet
17101QT*	Basin Faucet
19501QT*	Basin Faucet
19501S*	Basin Faucet
19501SH*	Basin Faucet
19501SW*	Basin Faucet
19503QT*	Basin Faucet
19544*	Shower Faucet
19574*	Free standing shower faucet

IAPMO RESEARCH AND TESTING, INC.

CERTIFICATE OF LISTING

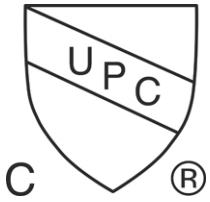

Issued To: KAIPING PASGO PLUMBING PRODUCTS CO., LTD.

Effective Date: November 2019

File Number: 10068

Product: Plumbing Fixture Fittings

Void After: November 2024

This certificate is not evidence of current listing. To verify listing status, visit the IAPMO R&T Product Listing Directory at pld.iapmo.org

Model Number	Description
19939*	Single Handle Concealed Shower Faucet
19940*	Single Handle Concealed Bath-shower Faucet
19949-01*	Pressure Balanced Tub & Shower Faucet
21001Q*	Basin Faucet
21003Q*	Basin Faucet
21013Q*	Basin Faucet
2903QT*	Basin Faucet
320QT*	Kitchen Faucet
3305QT*	Kitchen Faucet
3307Q*	Kitchen Faucet
3325QT*	Kitchen Faucet
3348Q*	Kitchen Faucet
3374B*	Free standing shower Faucet
3395QT*	Kitchen Faucet
3398QT*	Kitchen Faucet
5008Q*	Kitchen Faucet
7103Q*	Basin Faucet
7108Q*	Kitchen Faucet
8165QT*	Kitchen Faucet
8168Q*	Kitchen Faucet
8198Q*	Kitchen Faucet
8938Q*	Kitchen Faucet
K104336*	Hand Shower
*	represents different types of finishes as follows
01 or PC	Polished Chrome
02 or BN	Brushed Nickel PVD
03 or ORB	Oil Rubbed Bronze
04 or PN	Polished Nickel

IAPMO RESEARCH AND TESTING, INC.

CERTIFICATE OF LISTING

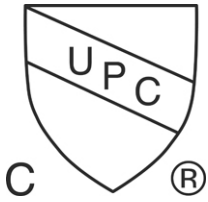

Issued To: KAIPING PASGO PLUMBING PRODUCTS CO., LTD.

Effective Date: November 2019

File Number: 10068

Product: Plumbing Fixture Fittings

Void After: November 2024

This certificate is not evidence of current listing. To verify listing status, visit the IAPMO R&T Product Listing Directory at pld.iapmo.org

* represents different types of finishes as follows

05 or W	White
06 or BC	Black and Chrome

Model Number	Description
14801QT*	Basin Faucet
14801HLQT*	Basin Faucet
22901QT*	Basin Faucet
23001QT*	Basin Faucet
22201SQT*	Basin Faucet
21413Q*	Basin Faucet
14805QT*	Kitchen Faucet
9328QT*	Kitchen Faucet
3308Q*	Kitchen Faucet
22205SQT*	Kitchen Faucet
21405Q*	Kitchen Faucet
21415Q*	Kitchen Faucet
A190*	Rainshower with shower arm
BC011*	Bath tub spout
9799-A172*	Hand shower
19939*	Pressure Balanced Tub & Shower Faucet
19939-0*	Rough-in
C113*	Trim kit

* represents different types of finishes as follows

01 or PC	Polished Chrome
02 or BN	Brushed Nickel PVD
03 or ORB	Oil Rubbed Bronze
04 or PN	Polished Nickel

IAPMO RESEARCH AND TESTING, INC.

CERTIFICATE OF LISTING

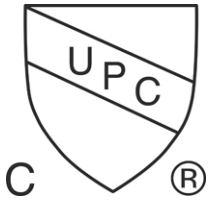

Issued To: KAIPING PASGO PLUMBING PRODUCTS CO., LTD.

Effective Date: November 2019

File Number: 10068

Product: Plumbing Fixture Fittings

Void After: November 2024

This certificate is not evidence of current listing. To verify listing status, visit the IAPMO R&T Product Listing Directory at pld.iapmo.org

Model Number	Description
K1003*	Basin Faucet
K1002*	Basin Faucet
K1001*	Basin Faucet
K5002*	Kitchen Faucet
K5001*	Kitchen Faucet
23401QT*	Basin Faucet
23301QT*	Basin Faucet
22301QT*	Basin Faucet
11008Q*	Kitchen Faucet
19930*	Pressure Balanced Tub & Shower Faucet
19930A*	Pressure Balanced Tub & Shower Faucet
19920*	Pressure Balanced Tub & Shower Faucet
19920A*	Pressure Balanced Tub & Shower Faucet
19940A*	Pressure Balanced Tub & Shower Faucet
19939A*	Pressure Balanced Tub & Shower Faucet
19949A*	Pressure Balanced Tub & Shower Faucet
BR1018*	SHOWER KIT
9758-A125*	Hand shower
QF-BR7037*	Rainshower with shower arm
QR-BR7036*	Rainshower with shower arm
BC004*	Bath tub spout
BC005*	Bath tub spout
19940*	Pressure Balanced Tub & Shower Faucet
19940-0*	Rough-in
2C113*	Trim kit
19939-01*	Pressure Balanced Tub & Shower Faucet
19939-03*	Pressure Balanced Tub & Shower Faucet
19939A-04*	Pressure Balanced Tub & Shower Faucet
19939-06*	Pressure Balanced Tub & Shower Faucet

IAPMO RESEARCH AND TESTING, INC.

CERTIFICATE OF LISTING

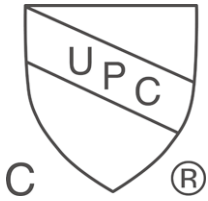

Issued To: KAIPING PASGO PLUMBING PRODUCTS CO., LTD.

Effective Date: November 2019

File Number: 10068

Product: Plumbing Fixture Fittings

Void After: November 2024

This certificate is not evidence of current listing. To verify listing status, visit the IAPMO R&T Product Listing Directory at pld.iapmo.org

Model Number	Description
19940-01*	Pressure Balanced Tub & Shower Faucet
19940-02*	Pressure Balanced Tub & Shower Faucet
19940-03*	Pressure Balanced Tub & Shower Faucet
19940A-04*	Pressure Balanced Tub & Shower Faucet
19940A-05*	Pressure Balanced Tub & Shower Faucet
19940-06*	Pressure Balanced Tub & Shower Faucet
19920-01*	Pressure Balanced Tub & Shower Faucet
19920-04*	Pressure Balanced Tub & Shower Faucet
19920A-06*	Pressure Balanced Tub & Shower Faucet
19920-08*	Pressure Balanced Tub & Shower Faucet
19930-01*	Pressure Balanced Tub & Shower Faucet
19930A-02*	Pressure Balanced Tub & Shower Faucet
46912Q*	Thermostatic Shower Faucet set
46924Q*	Thermostatic Shower Faucet set
D60	838*558*203(33"*22"*8") double bowl sink
*	represents different types of finishes as follows
01 or PC	Polished Chrome
02 or BN	Brushed Nickel PVD
03 or ORB	Oil Rubbed Bronze
04 or PN	Polished Nickel
05 or BG	Brushed Gold
06 or MB	Matte Black
07 or FB	Flat Black
08 or GW	Gold & White
09 or G	Gold
10 or PCW	Polish Chrome & White
11 or W	White

IAPMO RESEARCH AND TESTING, INC.

CERTIFICATE OF LISTING

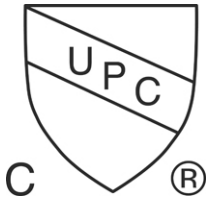

Issued To: KAIPING PASGO PLUMBING PRODUCTS CO., LTD.

Effective Date: November 2019

File Number: 10068

Product: Plumbing Fixture Fittings

Void After: November 2024

This certificate is not evidence of current listing. To verify listing status, visit the IAPMO R&T Product Listing Directory at pld.iapmo.org

Additional Company Information

FV America Corp.

Model Number	Description
Z181/D9F.0*	Basin Faucet
Z411.04/D9F*	Kitchen Faucet
Z115/D9F.0*	PRESSURE BALANCE SET
Z115.BASE*	ASSEMBLED CARTRIDGE BASE
Z412.01/T1F*	Kitchen Faucet
Z412.01/N1F*	Kitchen Faucet
Z115.17.2F*	Bath tub spout
Z129.04.F*	Hand shower
Z120.23.F*	Rainshower with shower arm
Z114.BASE*	ASSEMBLED CARTRIDGE BASE
Z114.D9F.0*	PRESSURE BALANCE SET

* represents different types of finishes as follows

CR	Polished Chrome
FB	Flat Black